

**Plan Information**

Tenure Type	Freehold
Plan Type	Strata Plan
Plan Purpose	Subdivision

**Plan Heading**

Lot 111 on Plan 7393

**Strata Scheme Details**

Scheme Name	DUNN BAY ROAD DUNSBOROUGH WA
Lodgement of scheme by-laws	YES

**Parcel Address**

DUNN BAY ROAD DUNSBOROUGH WA 6281

**Locality and Local Government**

Locality	DUNSBOROUGH
Local Government	SHIRE OF BUSSELTON

**Plan Examined**

Examined	Date
----------	------

**Endorsement Certificate**

WAPC Ref:	Delegated to LGA
-----------	------------------

~~Strata Titles Act 1985 - Section 15(4)  
 CERTIFICATE ENDORSING STRATA PLAN OR AMENDMENT OF A STRATA PLAN  
 BY WESTERN AUSTRALIAN PLANNING COMMISSION  
 It is hereby certified that the unconditional approval of the subdivision has been  
 granted by the Western Australian Planning Commission pursuant to section 15(4) of  
 the Strata Titles Act 1985.~~

For the Western Australian Planning Commission	Date
--	------

**In Order For Dealings**

Subject To	
------------	--

For Registrar of Titles	Date
-------------------------	------

**Plan Approved**

Inspector of Plans and Surveys	Date
--------------------------------	------

**Registered**

Application	
-------------	--

Date	Registrar of Titles	Seal
------	---------------------	------

**Survey Details**

Field Record	123456
Declared as Special Survey Area	No

**Survey and Plan Notation**

UNDER SECTION 32(2)(a) OF THE STRATA TITLES ACT 1985, NO PERSON SHALL OCCUPY ANY STRATA LOT CONTRARY TO THE PROVISIONS OF THE SHIRE OF BUSSELTON'S TOWN PLANNING SCHEME AND/OR ANY APPROVALS ISSUED PURSUANT TO THE TOWN PLANNING SCHEME BY THE SHIRE OF BUSSELTON.

SHOW THE USE RESTRICTION AS EITHER:  
 \* A STATEMENT IN THE BODY OF THE PLAN,  
 \* AS A NOTE ON THE ADMINISTRATION SHEET, OR  
 \* AS AN INTEREST IN THE NEW INTERESTS TABLE

**Survey Certificate - Regulation 54**

I,  
 hereby certify that this plan is accurate and is a correct representation of the -  
 (a) survey; and  
 (b) calculations from measurements recorded in the field records,  
 undertaken for the purposes of this plan and that it complies with the relevant  
 written law(s) in relation to which it is lodged.

Licensed Surveyor	Date
-------------------	------

**Survey Organisation**

Name	Xxx
Address	Xxx
Phone	Xxx
Fax	Xxx
Email	Xxx
Reference	Xxx

**Former Tenure**

New Lot / Land	Parent Plan Number	Parent Lot Number	Title Reference	Subject Land Description
1 -11 (Inclusive)	Plan 7393	Lot 111	Vol. 36 Fol. 260A	

**New Interests**

Subject	Purpose	Statutory Reference	Origin	Land Burdened	Benefit To	Comments
(6)	EASEMENT (Sewerage)	SEC 167 OF THE P&D ACT 2005, REG. 33 (e)	THIS PLAN	LOTS 1, 2, 3, 4 AND COMMON PROPERTY	WATER CORPORATION	
	USE RESTRICTION	SECTION 32(2)(a) OF THE STA 1985	THIS PLAN	LOTS 1 - 11 (Inclusive)	SHIRE OF BUSSELTON	NO PERSON SHALL OCCUPY ANY STRATA LOT CONTRARY TO THE PROVISIONS OF THE SHIRE OF BUSSELTON'S TOWN PLANNING SCHEME AND/OR ANY APPROVALS ISSUED PURSUANT TO THE TOWN PLANNING SCHEME BY THE SHIRE OF BUSSELTON.

**Lot / Sheet Index**

Lot	Total Area	Floors	Sheets
1	Xxx	Xxx	Xxx
2	Xxx	Xxx	Xxx
3	Xxx	Xxx	Xxx
4	Xxx	Xxx	Xxx
5	Xxx	Xxx	Xxx
6	Xxx	Xxx	Xxx
7	Xxx	Xxx	Xxx
8	Xxx	Xxx	Xxx
9	Xxx	Xxx	Xxx
10	Xxx	Xxx	Xxx
11	Xxx	Xxx	Xxx

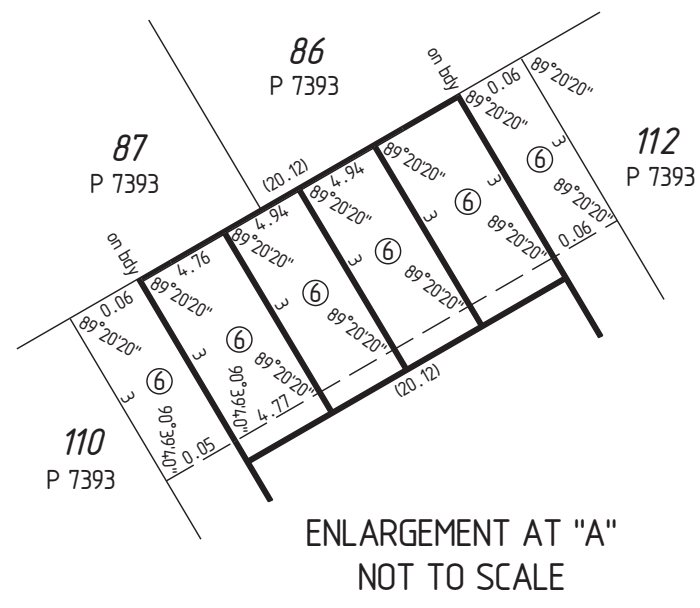
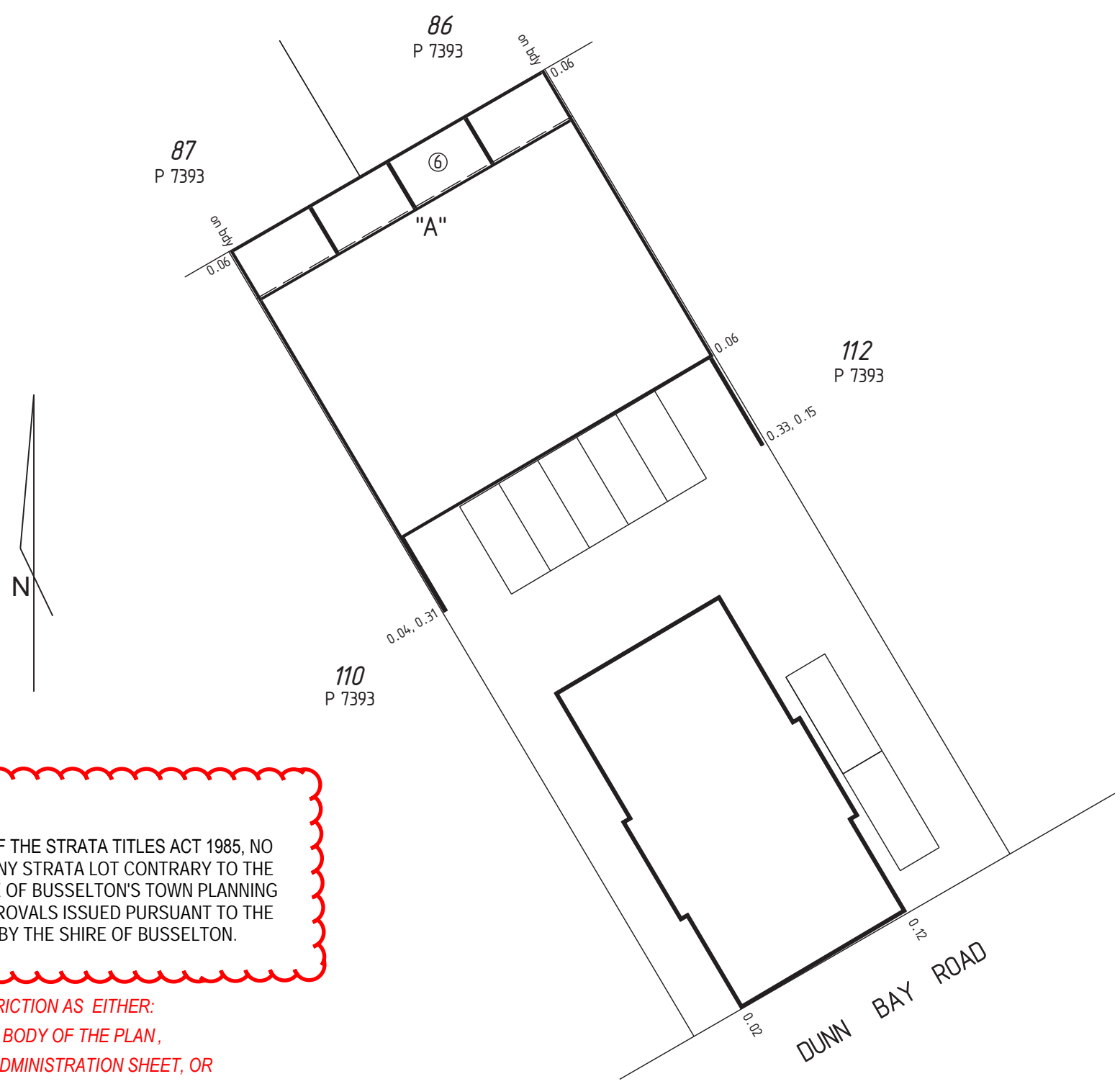

**USE RESTRICTION**

UNDER SECTION 32(2)(a) OF THE STRATA TITLES ACT 1985, NO PERSON SHALL OCCUPY ANY STRATA LOT CONTRARY TO THE PROVISIONS OF THE SHIRE OF BUSSELTON'S TOWN PLANNING SCHEME AND/OR ANY APPROVALS ISSUED PURSUANT TO THE TOWN PLANNING SCHEME BY THE SHIRE OF BUSSELTON.

- SHOW THE USE RESTRICTION AS EITHER:
- \* A STATEMENT IN THE BODY OF THE PLAN,
  - \* AS A NOTE ON THE ADMINISTRATION SHEET, OR
  - \* AS AN INTEREST IN THE NEW INTERESTS TABLE